

Order #: 22219704 (7441253)  
 Application Date: 7/2/2022 1:00 PM  
 Expiration Date: 7/16/2022



Driver	Rig	Hours	Completion

**\*\*REVISED\*\* Notice of Application / Recommendation**

**Nutrien Ag Solutions, Inc.**  
**WATSONVILLE CA (646)**  
**5 Lakeview Rd.**  
**Watsonville, CA 95076**  
**831-763-4533**

**Customer: GLEZ FARMS**  
**Account No: 1070040**  
**560 SALINAS RD**  
**ROYAL OAKS, CA 95076**

**\*\* NOI Required \*\***

Permittee	Location	Commodity	Restrictions
FRANCISCO GONZALES 17000 BLACKIE RD PRUNDALE CA 93907 Pmt #: 27-22-2700199 PO #:	RANCH 20 (GLEZ-02) Site ID: 020003 S/T/R: 23/12S/02E RANCH 20 BLOCK 3 GLEZ-02	BERRY, STRAWBERRIES  Planting 0 Planted acres 6.50 Treated acres 6.50	Harvest Days: Reentry Hrs: 168 Plantbacks: N Pasture days: 0 PPE Req: Y EPPE Req: Y Ntf Beekeeper: N Feed Waste: N Posting req: Y (by Applicator)

Instructions	Dilution/Band Info	Toxic To	Other
Location: Application: <b>DO SATURDAY. TARPED APPLICATION. 25FT BUFFER ZONE. THERE ARE NO POTABLE WELLS WITHIN 100FT. THERE ARE NO OCCUPIED STRUCTURES WITHIN 53FT. MIGUEL SANCHEZ QC90434-EXP 12/22- 831-594-6071 DOUG BARNES QAL 103398-831-245-9338. MAPS ATTACHED AR</b> Delivery:	Gal/Acre: 0.00 Row Spacing: 0	Fish: N Birds: Y Wildlife: N Bees: N	Closed System: Y Avoid Runoff: N Avoid Drift: Y Sig Word:

Product #	Product/Service Description	EPA #	Rate/Acre	Total Qty	Amt/100 Gal	Code / Pest
1000000158	CHEMIGATION	MISCELLANEOUS VENDOR	1.0000 AC	6.50 AC	0.0000	
1000187758	SET-UP FEE /EA	MISCELLANEOUS VENDOR	0.1538 EA	1.00 EA	0.0000	
*R* 1000012174	PIC-CLOR 60 EC 25GA CHLOROPICRIN	8536-43--11220 TRICAL INC	20.1000 GA	130.65 GA	0.0000	Nematode

Applicator Info/Method	County Info
NUTRIEN APPLIED 5 LAKEVIEW RD WATSONVILLE, CA 95076 831-763-4533 (37366) Chemigation	MONTEREY  , CA

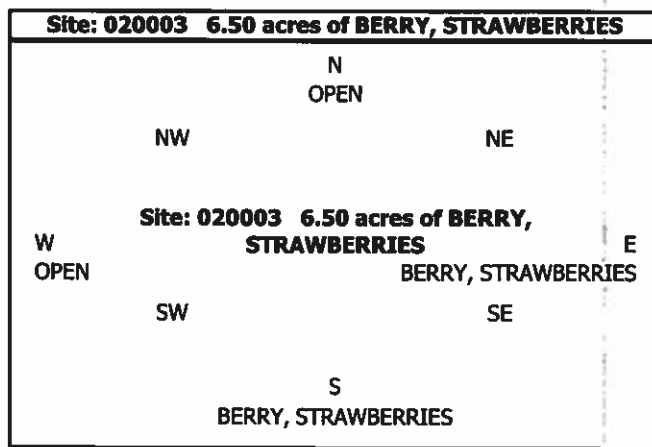

6/27/2022

Advisor: **Ochoa Angulano, Jose** PCA#: Order Date

I certify that I have considered alternatives and mitigation measures that would substantially lessen any significant impact on the crop or environment, and have adopted those found feasible.

Approved  Denied

County Representative Date



No Fume



No Fume



Hall District Elementary School

Ag well w/backflow prevention, low pressure drain. Well is at Ranch 15 with 676' away from fumigation cite.



Block 4  
Pic Clor 60 EC  
10 ac  
25' BZ  
20.1gal/ac

Block 3  
Pic Clor 60 EC  
6.5 ac  
25' BZ  
20.1gal/ac

Injection Point #2

Block 2  
Pic Clor 60 EC  
8.5 ac  
25' BZ  
20.1gal/ac

Block 1  
Pic Clor 60 EC  
9 ac  
25' BZ  
20.1gal/ac

Injection Point #1

Glez Farms

No Fume

Classic Salads Plant

